

OVERPRESSURE GAUGE PROTECTOR



Reotemp's Gauge Protector are designed to prevent instrumentation from experiencing overpressure or bursting due to unexpected pressure spikes. As pressure rises, a spring is compressed until a piston fully closes the process from the instrument. Once pressure reduces beyond 25% of set pressure, the valve reopens and the instrument returns to normal operation.

FEATURES / BENEFITS

- Saves Instrumentation from Excessive Pressure
- Set Valve in Field or at the Factory
- Various Materials of Construction Available

SPECIFICATIONS

Body Materials	316 Stainless Steel UNS 1.4571 (Standard)
Connection Sizes	1/2" (Standard) 1/4" BSPP M20 x 1.5
Max Allowable Pressure	Pressure: 8,700 psi (Regardless of Material or Spring Selection)
Max Allowable Temperature	175°F
Other Wetted:	Viton

VALVES

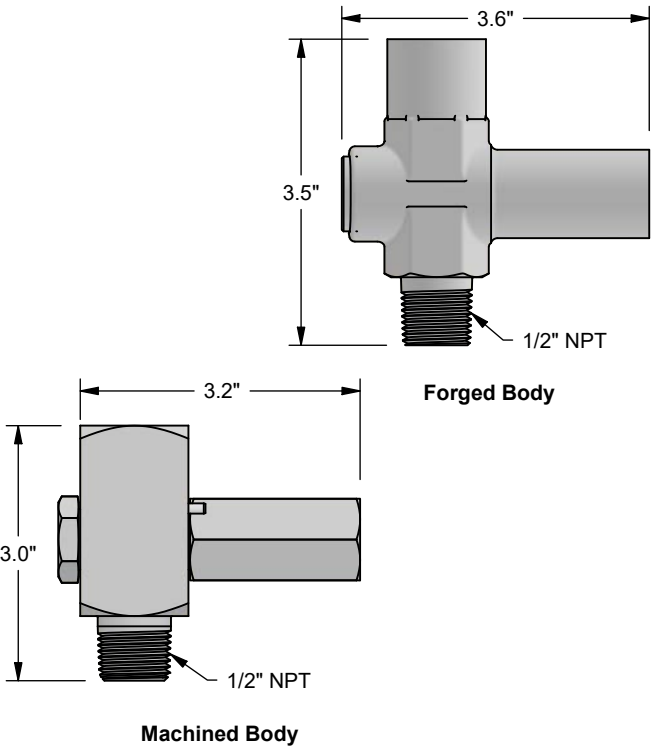

HOW TO ORDER: Choose options to build a part number. For example: PXGP2F2MS-1-A1PM

PXGP	2F2M	S	-1	-A1PM
MODEL	CONNECTION	BODY MATERIAL	SPRING RANGE	OPTIONS
PXGP = Overpressure Gauge Protector	2F2M = 1/2"F x 1/2"M 4F4M = 1/4"F x 1/4"M	Forged Body S = 316SS UNS 1.4571 B = Brass Machined Body M = Monel H = Hastelloy C-272	1 = 6 to 35 psi 2 = 30 to 85 psi 3 = 70 to 360 psi 4 = 290 to 870 psi 5 = 725 to 3,625 psi 6 = 3,480 to 5,800 psi 7 = 5,800 to 8,700 psi	FS = Set Valve at Factory A1 = Installed on Instrument (set at max instrument unless specified) NC = NACE MR0175 Compliant PM = PMI Test TS = Heavy Duty SS Tag SE = Snubber Installed for Water and Light Oils SG = Snubber Installed for Gas SD = Snubber Installed for Heavy Oils