

AMMONIA GAUGE

Ammonia pressure gauges are commonly used in industrial applications, particularly in refrigeration systems. They help monitor and maintain optimal pressure levels within the system to ensure efficient operation and safety. Ammonia pressure gauges are essential for industries such as food processing, cold storage, HVAC, and chemical manufacturing where ammonia is used as a refrigerant or in various processes.



PM40

PM25



Private Logos



Fillable



Custom Logo



Dials

FEATURES / BENEFITS

- Fully Welded Case to Socket - One Piece Design
- Silicone Filled Case Standard
- Customize/Personalized Logos Available

SPECIFICATIONS

Accuracy	4" = ±1% ASME Grade A, 2.5" = 1.6% ASME Grade B+, EN 837-1
Ambient Limits	-40°F/150°F
Process Limits	-40°F/250°F
Wetted Materials	Tube: 316SS Socket: 316SS
Lens	Polycarbonate (Standard), Tempered Glass, Laminated Safety Glass
Other Materials	Case: 304SS Ring: 304SS Dial: White Aluminum, Black Letters Case-to-Socket: Laser Welded
Fillable	Yes
Maximum Working Pressure	Stable = 100% Momentary = 130% of scale
Environmental Protection	NEMA 4X/IP65
Weight	2.5" = 0.35 lbs (0.5 lbs Filled), 4" = 0.8 (1.4lbs Filled)

AMMONIA GAUGE

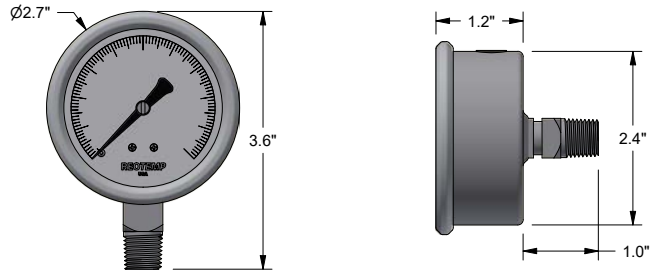

PM25

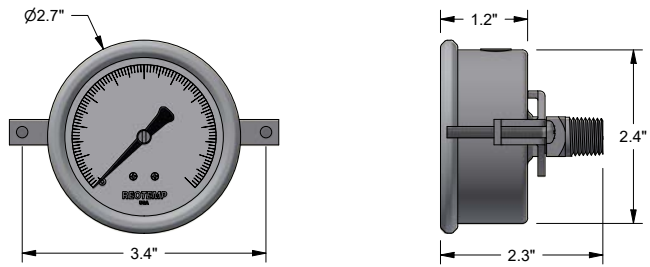

U-clamp

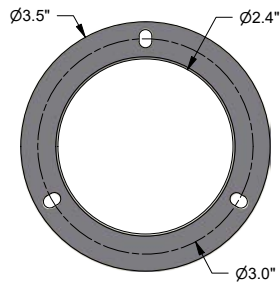

Mounting Flange

*dimensions in inches

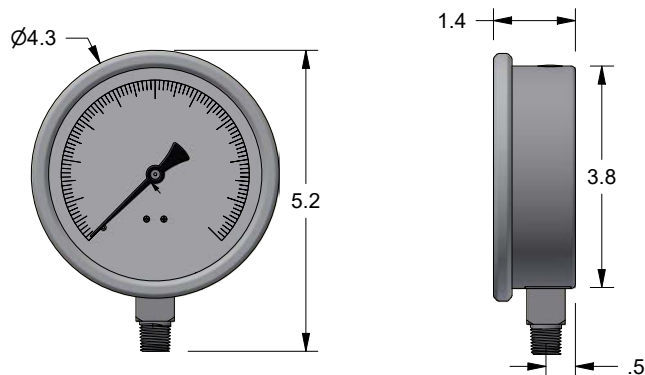







PM40 *dimensions in inches

AMMONIA GAUGE

PRESSURE GAUGES

HOW TO ORDER: Choose options to build a part number. For example: **PM25C1A4N06B-S-P**

PM25	C	1	A	4	N06B	-S	-P	
DIAL SIZE	CASE TYPE	TUBE & SOCKET	MOUNT TYPE	CONNECTION	RANGE CODE	CASE FILL	LENS	OPTIONS
PM25 = 2.5" PM40 = 4"	C = 304SS Case w/ Crimped Ring	1 = 316SS	A =  Bottom B =  Bottom/Rear Flange C =  Center Back D =  Center Back "U" Clamp E =  Center Back/Front Flange	4 = 1/4" NPT 2 = 1/2" NPT	N06B = Vac to 0 to 150 psi/ Ammonia N08 = Vac to 0 to 300psi/ Ammonia N06 = Vac to 0 to 160psi/ Ammonia N09 = Vac to 0 to 400psi/ Ammonia <i>Other Refrigerant Ranges Available: R404A, R22, R410A, R134A</i>	-S = Silicone Filled Case -G = Glycerin -W = Glycerin/ Water Filled -D = Dry	-P = Plastic -G = Glass	-HV = HiVis Dial -HG = Glow in the Dark Dial -UV = UV Protective Lens -C3 = 3pt. Calibration