

PISTON TYPE MECHANICAL DIFFERENTIAL PRESSURE GAUGE

PRESSURE GAUGES

Reotemp Series D20 Piston Type Mechanical Differential Pressure Gauges are primarily designed for liquid applications. Differential pressure is sensed by the movement of a precisely ground floating piston/magnet in a precision bore against a calibrated spring. A rotary pointer magnet located close to the internal magnet follows the movement of the piston magnet and indicates differential pressure on the dial. Piston type differential pressure gauges exhibit a slight amount of bypass as the fluid crosses from the high to the low pressure port.



D20



Fillable

FEATURES / BENEFITS

- Rugged, Compact, Cost Effective Design
- Weatherproof Rated to NEMA 4X/IP65
- Working Pressure Up to 6,000 psi
- Over-range Protection to Max Working Pressure
- Popular for Filters and Strainers
- ± 2% Full Scale Accuracy

SPECIFICATIONS

Accuracy	± 2% Full Scale
Ambient Limits	-40°F/130°F
Process Limits	-40°F/200°F
Process Limits with Diaphragm Seal	Series D20 cannot be mounted to a diaphragm seal. See series D40/42 for gauges mountable to a diaphragm seal.
Wetted Materials	Body: Aluminum, 316SS Internal Parts: SS Gasket/Seals: Buna, Viton, Teflon, Ethylene Propylene, or Perfluoroelastomer
Lens	Plastic (Standard) or Laminated Safety Glass
Other Materials	Case: Aluminum or Engineered Plastic Dial: White Aluminum, Black Letters
Fillable	Yes, Except for 3.5" Dial
Maximum Working Pressure	3,000 psi - Aluminum Body 6,000 psi - 316SS Body
Environmental Protection	NEMA 4X/IP65

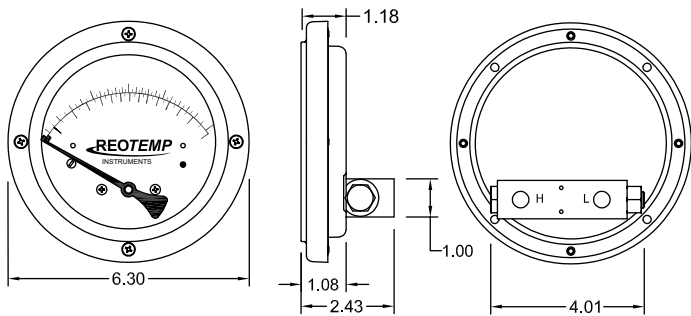

D20 4.5" Dial

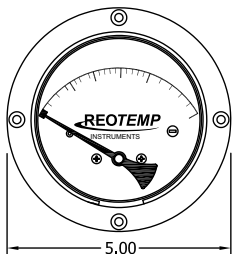

D20 3.5" Dial

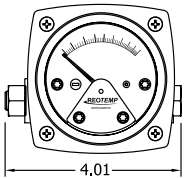

D20 2.5" Dial

PISTON TYPE MECHANICAL DIFFERENTIAL PRESSURE GAUGE

Visit reotemp.com

- ✓ Configure Part #
- ✓ Generate a Custom Engineering Drawing
- ✓ Get Price
- ✓ Download PDF Data Sheets

HOW TO ORDER: Choose options to build a part number. For example: D202PAB-B4XXX-PD5-M1

D20	2P	A	B	-B4	XX	X
SERIES	DIAL SIZE/ CASE MATERIAL	BODY/ INTERNALS	DIAPHRAGM & GASKETS	PROCESS CONNECTION	SWITCH OR TRANSMITTER TYPE & HOUSING	ELECTRICAL SPECIFICATION
D20 = Mechanical DP Gauge Piston Style (5-110 psid)	2P = 2.5" Dial, Plastic Case 4P = 4.5" Dial, Plastic Case 3A = 3.5" Dial Aluminum Case 4A = 4.5" Dial, Aluminum Case	A = Aluminum/ SS S = 316SS/SS Wetted	B = Buna-N V = Viton E = Ethylene Propylene P = Perfluoro-elastomer Wetted	-B4 = 1/4" NPTF back -E4 = 1/4" NPTF end connection -L4 = 1/4" NPTF bottom -E2 = 1/2" NPTF end adapters	XX = None A3 = Single Reed Switch, Flying Leads with Grommet Wire Seal A4 = Dual Reed Switch, Flying Leads with Grommet Wire Seal A5 = Single Reed Switch, Flying Leads with 1/4" FNPT NEMA4X A6 = Dual Reed Switch, Flying Leads with 1/4" FNPT NEMA4X D3 = Single Reed Switch, Explosion Proof Enclosure* D4 = Dual Reed Switch, Explosion Proof Enclosure*	X = None A = SPDT, 3W, .25Amp 125VAC/Vdc B = SPST, 60W, 1.0Amp 240VAC/Vdc

*Complete assembly rated class 1, Div. 2, groups A, B, C, D; Class II, Div. 2, Groups F&G

-PD5

-M1

PRESSURE RANGE

-PD5 = 0-5 psid
-PD10 = 0-10 psid
-PD20 = 0-20 psid
-PD50 = 0-50 psid
-PD100 = 0-100 psid

For Additional Range Codes See Page 85

OPTIONS

-M1 = 2" Pipe Mounting Kit with Carbon Steel Bracket
-M2 = 2" Pipe Mounting Kit with Stainless Steel Bracket
-M3 = Wall Mounting Kit
-SG = Laminated Safety Glass (ONLY with 4A Dial)
-MP = Max Pointer (Not Available with SG or LF)
-LF = Liquid fill (Not Available with 3A Dial)
-TS = SS Tag
-OX = Cleaned for oxygen service

PRESSURE GAUGE RANGES AND CODES

SPECIAL RANGE TYPES

Receiver Ranges			Refrigerant Ranges			Tank Level Ranges	
Code	Element	Dial Range	Code	Dial Range	Refrigerant	Code	Range
P60	3-15 psi	0-100%	N06	-30inHg to 160 psi	Ammonia	F14	0-24ft H ₂ O
P61	3-15 psi	0-10 sq rt	R06	-30inHg to 160 psi	R134A	F15	0-30ft H ₂ O
P62	3-15 psi	0-100% & 0-10 sq.rt.	R06A	-30inHg to 160 psi	R22	F15C	0-40ft H ₂ O
			R06C	-30inHg to 160 psi	R404A	F16	0-60ft H ₂ O
			N07	-30inHg to 200 psi	Ammonia	F165	0-100ft H ₂ O
			N08	-30inHg to 300 psi	Ammonia		

DIFFERENTIAL PRESSURE RANGES (DP GAUGES ONLY)

psid		inH ₂ Od		bard		mbard		kPad	
Code	Range	Code	Range	Code	Range	Code	Range	Code	Range
PD1	0-1 psid	ID10	0-10 inH ₂ Od	BD1	0-1 bard	MD40	0-40 mbard	AD2.5	0-2.5 kPad
PD3	0-3	ID20	0-20	BD1.6	0-1.6	MD60	0-60	AD6	0-6
PD5	0-5	ID30	0-30	BD2.5	0-2.5	MD100	0-100	AD10	0-10
PD10	0-10	ID50	0-50	BD4	0-4	MD160	0-160	AD25	0-25
PD20	0-20	ID100	0-100	BD6	0-6	MD250	0-250	AD40	0-40
PD50	0-50	ID150	0-150	BD7	0-7	MD400	0-400	AD100	0-100
PD100	0-100	ID200	0-200	BD11	0-11	MD600	0-600	AD250	0-250
PD200	0-200	ID400	0-400	BD55	0-55	MD1000	0-1000	AD700	0-700
PD6000	0-6000			BD400	0-400				